

CAPS - CSA ALLOY WHEELS

CSA IMPORT RANGE - CLIP IN CAPS LARGE & SMALL PASSENGER	PART NO	CAP DIAM	LOGO DIAM	WHEEL CLIP IN DIAM	CAP HEIGHT	SCREW SIZE
		A	B	C	D	
CHROME CAP CSA EMBOSSED	401-C153	60	EMB	57	7	N/A
CHROME DOME CAP CSA EMBOSSED	401-C153D	60	EMB	57	13	N/A
CHROME CAP CSA WITH 44MM LOGO	401-C154	60	44	57	7	N/A
CHROME CAP CSA WITH 56MM LOGO SUIT CALIBRE, CONQUEST	401-149K59-A	59	56	56	9	N/A
CHROME CAP CSA WITH 55MM LOGO SUIT DIABLO	401-C191	65	55	59	6	N/A
CHROME DOME CAP CSA EMBOSSED SUIT ALL SNIPER & EDGE 2009-	401-C155	74	EMB	72	18	N/A
CHROME DOME CAP CSA 45MM LOGO SUIT EDGE 2013+ & SWORD 20	401-537	68	45	64	17	N/A
CHROME DOME CAP CSA WITH 45MM LOGO SUIT ELICIT	401-241K64-B	64	45	58	15	N/A
CHROME DOME CAP CSA WITH 45MM LOGO SUIT FIRENZE	401-241K64	64	45	58	16	N/A
CHROME DOME CAP CSA WITH 56MM LOGO SUIT EMOTION & NITROU	401-C138	68	56	64	13	N/A
CHROME CAP CSA 56MM LOGO SUIT INSTINCT, MOTEGA, MOTO 17X7 201	401-619	60	56	58	7	N/A
CHROME CAP CSA WITH 65MM LOGO SUIT PULSE	401-208B	68	65	64	8	N/A
BLACK CAP CSA WITH 45MM LOGO SUIT RACETEK	401-847	61	45	57	21	N/A

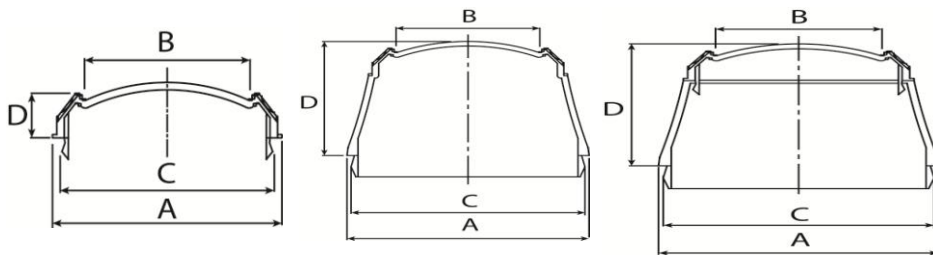

CSA IMPORT RANGE 4X4 & SUV - CLIP IN CAPS 2008+	PART NO	CAP DIAM	LOGO DIAM	WHEEL CLIP IN DIAM	CAP HEIGHT	SCREW SIZE
		A	B	C	D	
CHROME MEDIUM PLUS ONE PIECE CAP CSA EMBOSSED	401-178-SC	84	EMB	80	56	N/A
6-LUG CHROME ONE PCE CAP EXTRA SHORT CSA EMBOSSED	401-180-6XS	134	EMB	130	57	N/A
6-LUG CHROME 2 PCE LONG CAP CSA EMBOSSED	401-180-6L	134	EMB	130	105	N/A
6-LUG CHROME 2 PCE SHORT CAP CSA EMBOSSED	401-180-6S	134	EMB	130	75	N/A
5-LUG CHROME 2 PCE CAP CSA EMBOSSED	401-180-5S	134	EMB	130	88	N/A
CHROME END CAP ONLY CSA EMBOSSED - SUIT 180 SERIES CAPS	401-178-EC	106	EMB	72	24	N/A
CHROME CLIP IN CAP CSA EMBOSSED SUIT ALL 18" & 20" MONSTER	401-C155A	78	EMB	71	18	N/A
JACKAL & RAPTOR 6/114.3, 5/114.3, 5/120, 5/127 PCD'S						
BLACK CAP CLIP IN CSA SUIT GRANITE 6/114.3, 5/114.3, 5/120, 5/127 P	401-130B	78	EMB	71	18	N/A

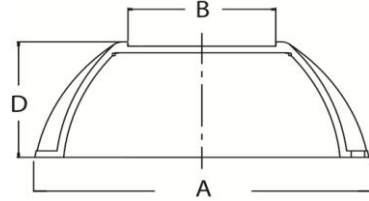
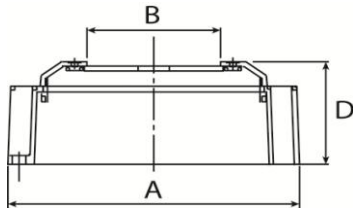

CSA IMPORT RANGE 4X4 & SUV - SCREW ON CAPS	PART NO	CAP DIAM	LOGO DIAM	WHEEL CLIP IN DIAM	CAP HEIGHT	SCREW SIZE
		A	B	C	D	
6-LUG ONE PIECE FLUTED CHROME CAP SUIT MONSTER 16X7 P35 6/1	401-156	137	60	N/A	53	M4X13
5-LUG CHROME CAP CSA 2 PIECE SUIT JACKAL 5/150MM PCD	401-C139	140	64	N/A	53	M6X16
6-LUG CHROME CAP CSA 2 PIECE SUIT JACKAL & TANAMI 6/139.7MM	401-C140	140	64	N/A	53	M6X16
5-LUG BLACK CAP CSA/MULLINS PREMIUM 2 PIECE RAPTOR 5/150MM	401-C139B	140	64	N/A	53	M6X16
6-LUG BLACK CAP CSA/MULLINS PREMIUM 2 PIECE RAPTOR 6/139.7M	401-C140B	140	64	N/A	53	M6X16
5 LUG BLACK CAP CSA 1 PIECE SUIT GRANITE 5/150MM PCD	401-131-5B	140	N/A	N/A	56	M6X16
6 LUG BLACK CAP CSA 1 PIECE SUIT GRANITE 6/139.7MM PCD	401-132-6B	140	N/A	N/A	56	M6X16
CAP SCREW 4MMX13MM (PHILIPS HEAD TYPE)	405-M4X13	N/A	N/A	N/A	N/A	M4X13
CAP SCREW CHROME 6MMX16MM SOCKET HEAD	405-M6X16C	N/A	N/A	N/A	N/A	M6X16
CAP SCREW BLACK 6MMX16MM SOCKET HEAD	405-M6X16B	N/A	N/A	N/A	N/A	M6X16
HEX KEY 5 MM TO SUIT CAP SOCKET HEAD SCREW	405-F502	N/A	N/A	N/A	N/A	N/A

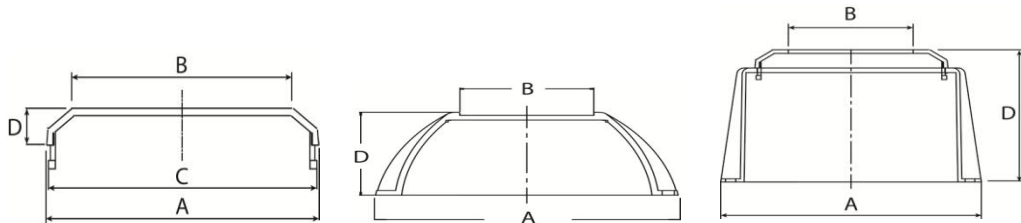

CSA AUST ALLOY RANGE 4X4 & SUV - SCREW ON CAPS SUIT WHEELS UP TO 2009	PART NO	CAP DIAM	LOGO DIAM	WHEEL CLIP IN DIAM	CAP HEIGHT	SCREW SIZE
		A	B	C	D	
1 PCE FLUTED CHROME CAP 6 LUG CSA 60MM LOGO	401-156	137	60	N/A	53	M4X13
2 PCE FLUTED CHROME CAP 6-LUG ASSY CSA 70MM LOGO	401-173	137	70	N/A	105	M4X13
2 PCE FLUTED CHROME CAP 6-LUG SHORT ASSY CSA 70MM LOGO	401-173S	137	70	N/A	77	M4X13
2 PCE FLUTED CHROME CAP 5-LUG ASSY CSA 70MM LOGO	401-173-5	137	70	N/A	88	M4X13
CHROME END CAP ONLY CSA - SUIT 173, 173S AND 173-5 CAP	401-172	104	70	99	12	N/A
CAP SCREW 4MMX13MM LONG (PHILIPS HEAD TYPE)	405-M4X13	N/A	N/A	N/A	N/A	M4X13

CSA AUST ALLOY RANGE - CLIP IN CAPS	PART NO	CAP DIAM	LOGO DIAM	WHEEL CLIP IN DIAM	CAP HEIGHT	SCREW SIZE
		A	B	C	D	
CHROME MEDIUM PLUS ONE PIECE EMBOSSED CAP	401-178-SC	84	EMB	80	56	N/A
RIVETTED CHROME CAP CSA 44MM LOGO	401-C165C	67	44	61	20	N/A
FLAT PLASTIC CAP CSA 60MM LOGO	401-C179A	60	60	56	8	N/A
DOME CAP CHROME CSA 44MM LOGO SUIT PREDATOR	401-C170C	60	44	56	17	N/A

CSA CAPS - SUPERSEDED FITMENTS	PART NO
CAP HAZE 18" CHROME SUIT CHROME WHEELS	401-C145
CAP STINGER ALL FITMENTS	401-C144
CAP HAZE 17" & HAZE 18" SUIT MACHINED FACE WHEELS	401-C146
CAP HAZE 20" SUIT MACHINED FACE WHEELS	401-C147
CAP STEALTH 5/114.3 PCD	401-C153
CAP STEALTH SUV (NOT 5/1143) CHROME	401-C148
CAP SUBB 18" & SUBB 20" CHROME	401-C149
CAP TEASE 18" & TEASE 20" CHROME	401-C150
CAP SCREW M8X20 SUIT TEASE 18" & 20" CAP	405-M8X20
CAP SCREW M8X25 SUIT HAZE (ALL) & 18" SUBB CAP	405-M8X25
CAP SCREW M8X30 SUIT SUBB 20" CAP	405-M8X30
HEX CAP KEY 6MM SUITS ALL 8MM CAP SCREWS.	405-F500